

( D3 B3)

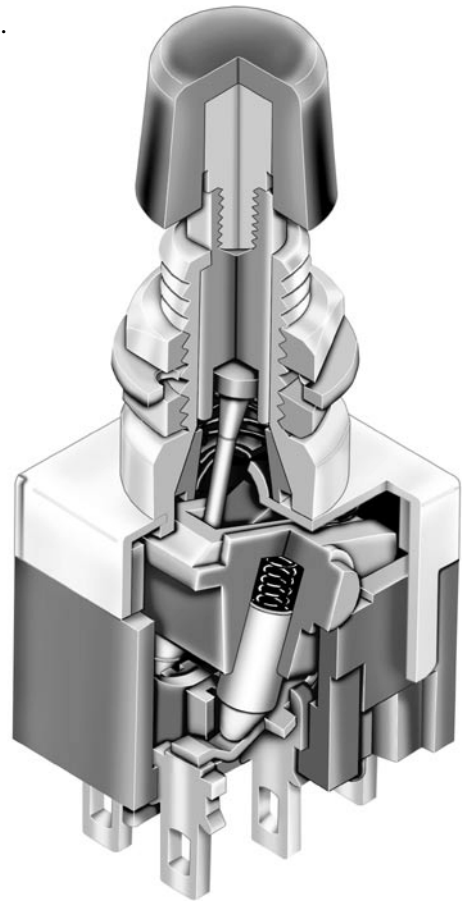

1500

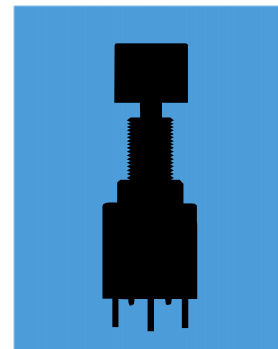

( W): 6A 125 3A 250 3A  
 ( G): 0.1 -0.1 0.4 20 -28 ) / 28 ( )  
 ( A): W G " "

10 20  
 1 000 500  
 1000 1 ;  
 1500 1  
 50 000 ; 100 000  
 25 000 50 000  
 50 000 3 125  
 : 1- 4.41 ;2- 7.06 ;4- 11.77 ;2- 9.32 ;4- 16.18 ;25.54 ;

( ) ( )  
 ( )  
 .028" (0.71 ) .110" (2.80 ) .125" (3.19 )  
 .043" (1.09 ) .043" (1.10 ) .050" (1.26 )  
 .071" (1.80 ) .153" (3.90 ) .175" (4.45 )

B1  
 (UL94V-0)

( A) ( W); ( G)  
 ( G); ( A) ( W);  
 -30°C +85°C  
 90 ~ 95% 96 40°C  
 10 ~ 55 1.5 1 ;  
 2

50 G (490 / 2) ( ,5  
 B3 D3 IP67  
 1.5 ;0.7  
 80  
 : . A " "  
 : . A " "

UL C-UL: UL94V-0 6 125 3  
 250 , 0.4 28 ;UL  
 WOYR2.E44145, UL "U" .C-  
 UL No. WOYR2.E44145; "/C-UL" C-UL

CSA: 250 , .4 6 125 , 3  
 CSA No. 023535-0-000; "/C" t CSA



**MB**

**2011**

**S**

**S1**

**W**

**01**

**C**

**A**

2011	SPDT	ON	( )
2065	SPDT	ON	ON
2061	DPDT	ON	( )
2085	DPDT	ON	ON
2181	4PDT		( )
2185	4PDT		ON
( ) =			

W	6A	;	125	( )	3A	250
G		;	0.4			28
A		6A				
	0.4		125			28

B	.315" (8.0 )
C	.394" (10.0 )

A
B
C
E
F
G
H

S
L

S1	0.335" (8.5 )
S2	0.335" (8.5 )
S4	0.335" (8.5 )
D1	0.335" (8.5 ) D-
D3	0.335" (8.5 )

01	
02	
03	0.250" (6.35 )
05	0.425" (10.8 )
06	0.750" (19.05 )
07	0.964" (24.5 )
08	1.062" (27.0 )



CSA,

UL, C-UL

**MB2011SS1W01-CA**

(10.0 )

.394"

0.335" (8.5 )

SPDT

-( )

6



		( ) =					
SP	MB2011 MB2065		( )	2-3	2-1	SPDT	
DP	MB2061 MB2085		( )	2-3 5-6	2-1 5-4	DPDT	
4P	MB2181 MB2185		( )	2-3 5-6 8-9 11-12	2-1 5-4 8-7 11-10	4PDT	

## S

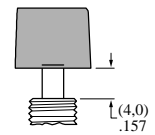
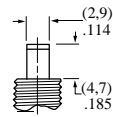
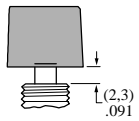
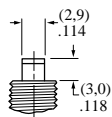

## L

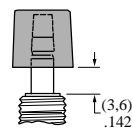
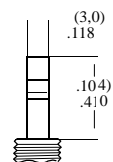

**S1** 0.335" (8.5 )

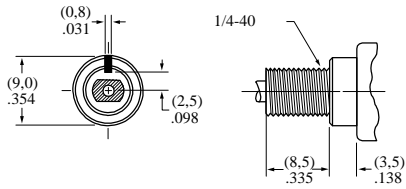

**S2** 0.335" (8.5 )

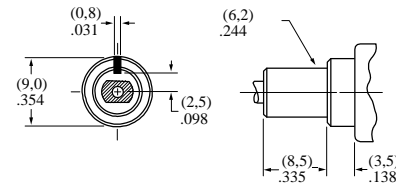

**S4** 0.335" (8.5 )

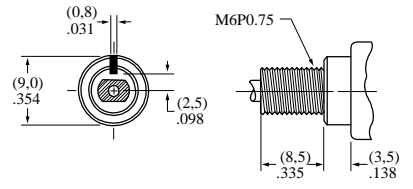

: 0.154" (3.9 )

: 0.154" (3.9 )

**D1** 0.335" (8.5 )  
D-

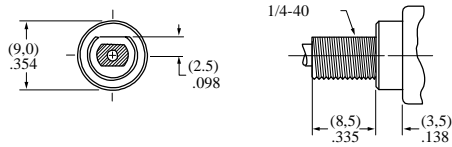

**D3** 0.335" (8.5 )

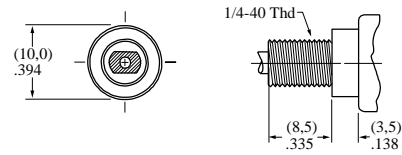

: 0.154" (3.9 )

: 0.240" (6.1 )

S1, S2 S4

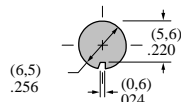

S1 S4

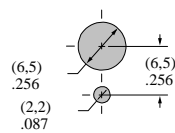

S1, S4 D1 2  
1 1

D1 c

D-

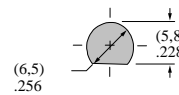

, 1

D3

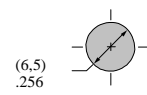

; D3

**W**

6A 125 ( ) 3A 250 ( )

**G**

0.4 . 28 ( / ) .  
: " "

**A**

250 6A 125 3  
/ 0.4 28  
: " "

**01**

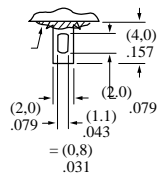

**02**

0.062" (1.57 )

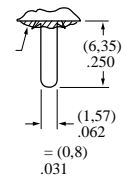

**03**

0.250" (6.35 )

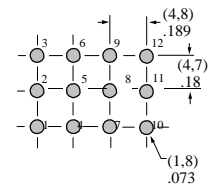
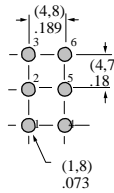
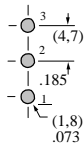
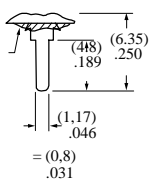

**05**

0.425" (10.8 )

**06**

0.750" (19.05 )



A =

**07**

0.964" (24.5 )

**08**

1.062" (27.0 )

**B**

AT413  
.315" (8.0 )

AT443

8.0

S :  
:

L

:

**C**

AT407  
.394" (10.0 )

AT442

10.0

S :  
:

L

:

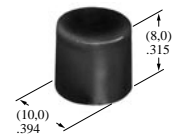
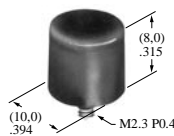
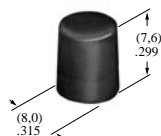
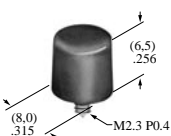

**A**

**B**

**C**

**E**

**F**

**G**

**H**

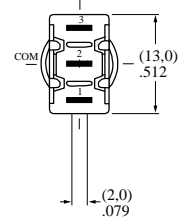
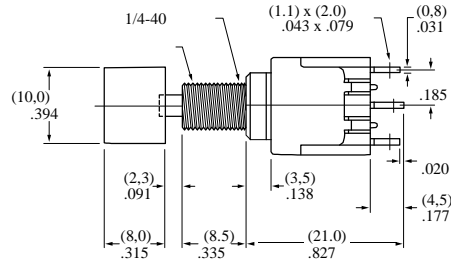
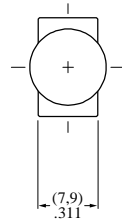

MB2011SS1W01-CA

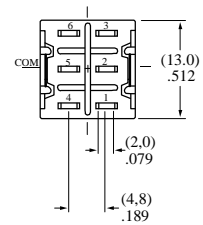
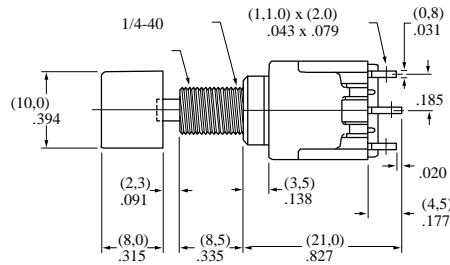
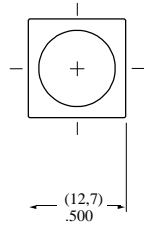

MB2061SS1W01-CA

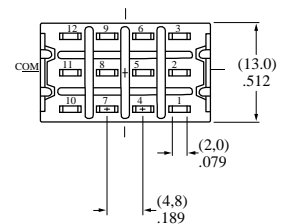
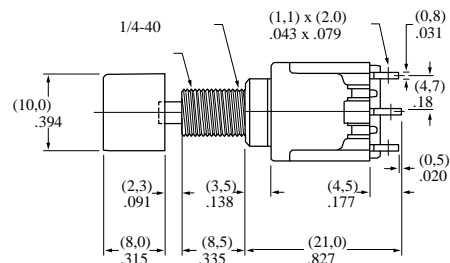
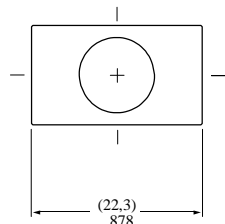

MB2181SS1W01-CA

AT513H  
AT513M

2  
(1)

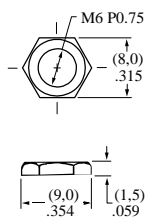

AT509

1 ( )

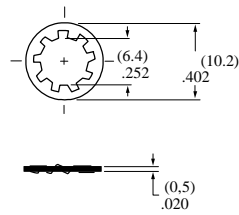

AT516

1

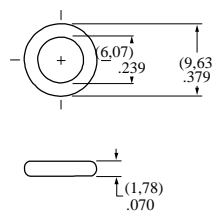

AT507H  
AT507M

1 : /

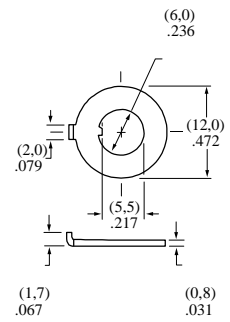

/

S

AT512H  
AT512M

.315" (8.0) ( B)

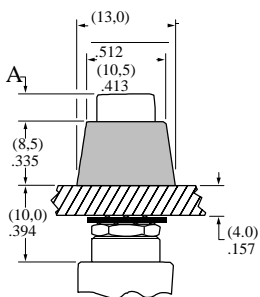

A =

AT512H  
AT512M

.394" (10.0) ( C)

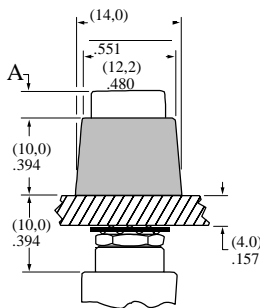

AT4041H  
AT4041M



M2.3 P0.4

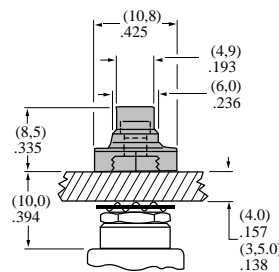

100,000

AT4042H  
AT4042M

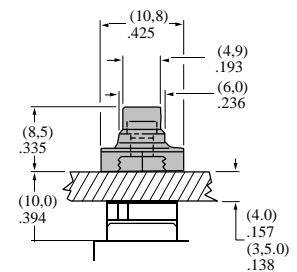

30 000

.091" (2.3) )  
.157" (4.0) )  
.142" (3.6) )

S  
S  
L